



## EV Charging Solution

# DC Charger / City Charger 100kW

- 50/100kW fast charging with  $\geq 94\%$  efficiency
- All-weather outdoor design for high environmental adaptability
- Complete system integration for better charging services



Highway  
Service



Parking



Service  
Station



Commercial  
Areas



Traffic  
Hub



# Speed up Urban Life with EV Fast Charging

Delta City Charger is an ideal solution for high efficiency urban charging service. It supports simultaneous charging output and load distribution to optimize utilization rate of the charging site. Delta City Charger is compatible to OCPP which allows further backend

system integration like user management, remote control and energy management.



## Application Scenario

### Charging Network

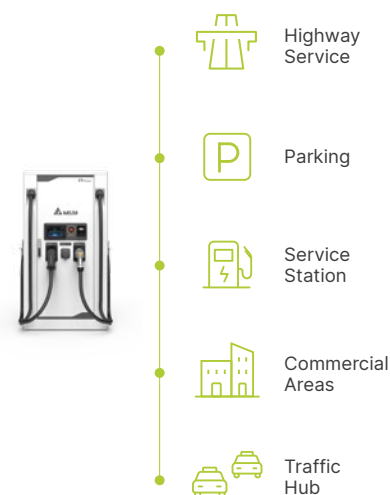

### Backend Office

EV Charging Network Management System



Mobile App access for remote control

### Applications

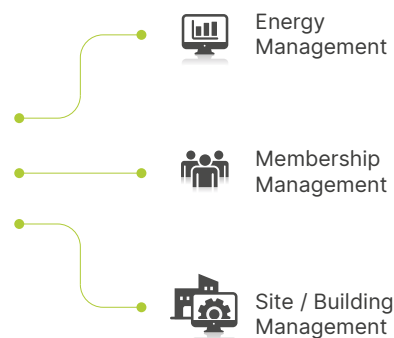

... and more

## Feature Highlights



50/100kW fast charging  
with  $\geq 94\%$  efficiency

- 50kW / 100kW simultaneous charging
- Dynamic load distribution optimizes charging service



All-weather outdoor design  
for high environmental adaptability

- IP55 and IK10 protection
- Forced air cooling
- Protection : over current, under voltage, over voltage, surge protection, short circuit, over temperature, ground fault



Complete system integration  
for better charging services

- Support OCPP1.6-J, upgradeable to OCPP2.0
- Built-in Ethernet, Cellular (3G/4G) and WLAN connectivity

## Product at a Glance

**Network Connectivity**  
Ethernet, Cellular, Wi-Fi

**User Authentication**  
Credit card, RFID reader,  
ISO 15118\*

**Charging Standard**

- CHAdeMO, CCS2
- AC Type 2 socket

**Protection**  
IP55, IK10



Pluggable Power Module

## Cable Management

### Balancing System for City Charger

A pair of balancing system stands is needed to manage the charging cables of dual-connector models. The design utilizes the weight stacks, paracord, and pulleys to balance the pull force on the charging cable. It provides a better user experience by helping the users hold the cable, move the charging cable, and return the charging cable more easily. In addition, the mechanism holds the cable so that it will be well organized instead of lying on the ground.

On-side Installation

Front side Installation

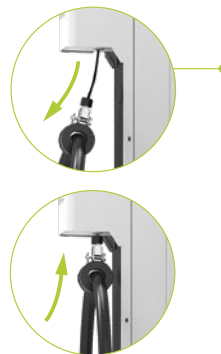

Balancing system for helping  
users hold and move charging cable easier.

# Specifications

Part Number	EVHE104-	EVHE503-
Description	100 kW Dual Output DC Charger	50 kW Dual Output DC Charger
<b>Power Input</b>		
Input Rating	380-415 Vac, 3-Phase, 50 / 60 Hz, L1, L2, L3, N, PE	
Power Factor	0.99 at nominal output	
Efficiency	94% at nominal output power	
<b>Power Output</b>		
Output Voltage	50 – 1000 Vdc	
Output Interface	DC output options: CCS2, CHAdeMO AC output option: Type 2 Socket	
DC Output Current	200 A max.	125A max.
DC Output Power	100 kW max.	50kW max.
AC Output Current	3-Phase 32 A max.	
AC Output Power	22 kW max.	
<b>Protection</b>		
Protection	Over current, Under voltage, Over voltage, Surge protection, Short circuit, Over temperature, Ground fault	
<b>User Interface &amp; Control</b>		
Display	7 inch LCD touch panel	
Support Language	English (Other languages available upon request)	
Push Buttons	1 emergency stop button	
Charge Options	Simultaneous charging and configurable dynamic load distribution (dual outputs)	
User Authentication	ISO / IEC 14443 A / B Mifare RFID reader, Credit card reader (optional)	
<b>Communication</b>		
Network Interface	Ethernet, Cellular, WLAN	
Protocol	OCPP1.6-J, upgradable to OCPP2.0	
<b>Environmental</b>		
Operating Temperature	Operating from -30 °C to +50 °C, derating from +50 °C to +60 °C	
Storage Temperature	-40 °C to +80 °C	
Humidity	< 95% relative humidity, non-condensing	
Altitude	2,000 m	
<b>Mechanical</b>		
Ingress Protection	IP55	
Enclosure Protection	IK10 according to IEC 62262	
Cooling	Forced air	
Charging Cable Length	4 m (standard) ; 7 m (optional)	
Dimension (W x H x D)	800 × 1500 × 590 mm	
Weight **	350 kg	290 kg
<b>Regulation</b>		
Certificate	CE	
<b>Installation</b>		
Accessory	Cable management	

\* ISO 15118 in plan \*\* Dimension and weight including 4 m charging connectors, subject to variants. Product outlook depends on configuration. Specifications are subject to change without notice.

Item	Cable Management
Manageable cable length	4m
Placement	Front sides of charger, on-site installation
Dimension (W x D x H)	110 × 235 × 1502 mm, 29kg
Recoiler cable length	2 m with paracord inside
Internal counterweight	Depending on the weight of the charging cable



More information

## Delta Electronics (Thailand) PCL.

909 Soi 9, Moo 4, Bangpoo Industrial Estate (E.P.Z), Pattana 1 Rd.,

T.Phraksa, A.Muang, Samutprakarn 10280, Thailand

TEL : +66 (0) 2709-2800 | FAX: +66 (0) 2709-3200

For more product information and sales inquiries, Please contact [ev.det@deltaww.com](mailto:ev.det@deltaww.com)

[www.DeltaThailand.com](http://www.DeltaThailand.com)



2023/03